

Scale 10 Perches to an Inch

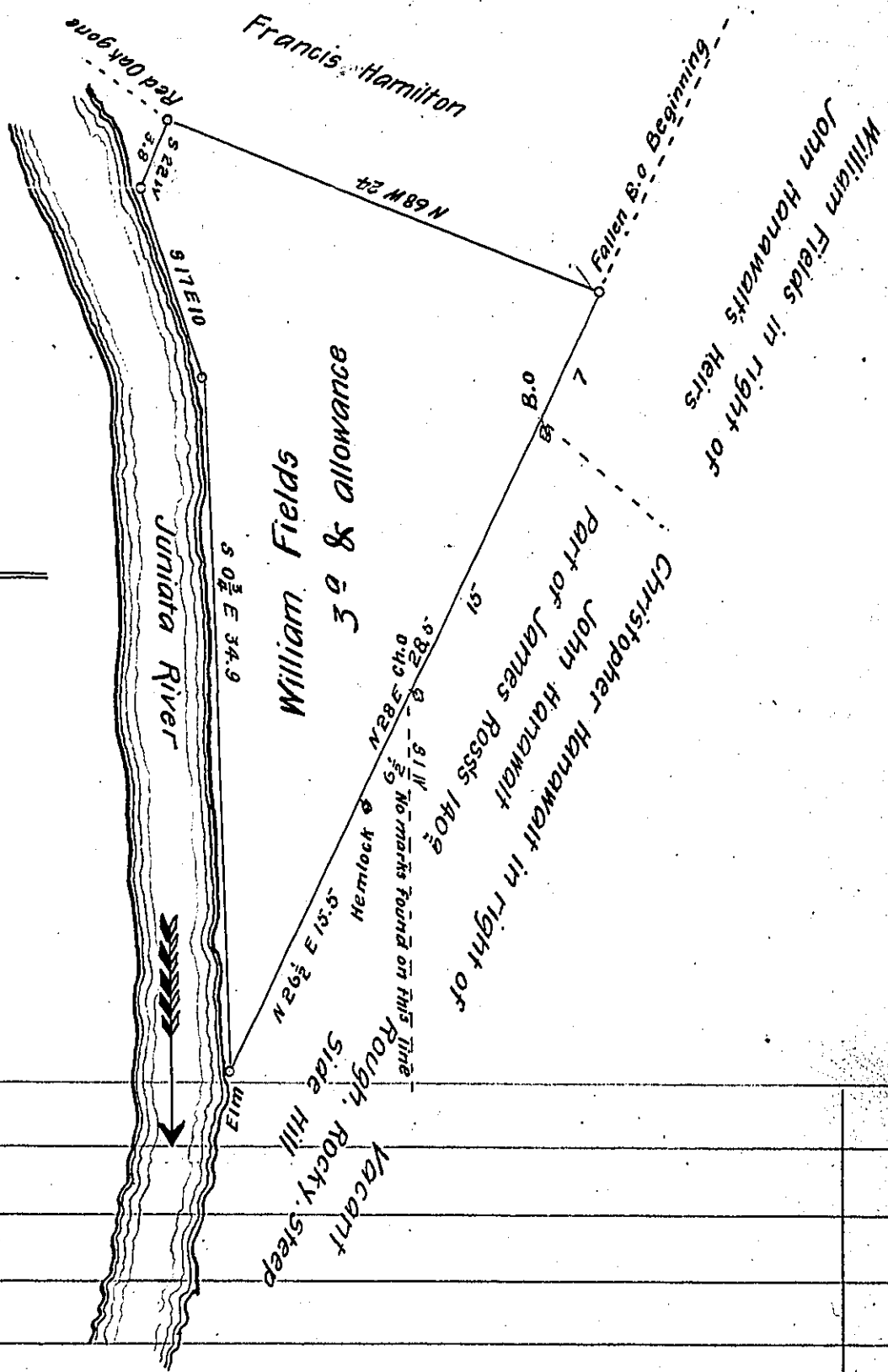

A Draught of three acres of land with allowance of Six Per Cent for Roads &c.  
 situate in Wayne Township Mifflin County. Surveyed October 6<sup>th</sup> 1859 for  
 William Fields who obtained a Warrant for it dated October 7<sup>th</sup> 1859.

John Swartzell C.S.

To John Rowe Esq.

Surveyor General of Penn<sup>a</sup>

IN TESTIMONY that the above is a copy of the original remaining on file in  
 the Department of Internal Affairs of Pennsylvania, made  
 conformably to an Act of Assembly approved the 16th day of  
 February, 1833, I have hereunto set my Hand and caused  
 the Seal of said Department to be affixed at Harrisburg,  
 this seventh day of October 1904.

*Loe B. Brown*  
 Secretary of Internal Affairs.